

## 22.2 Outdoor Unit

### 22.2.1 CU-Z20VKE CU-Z25VKE CU-Z35VKE

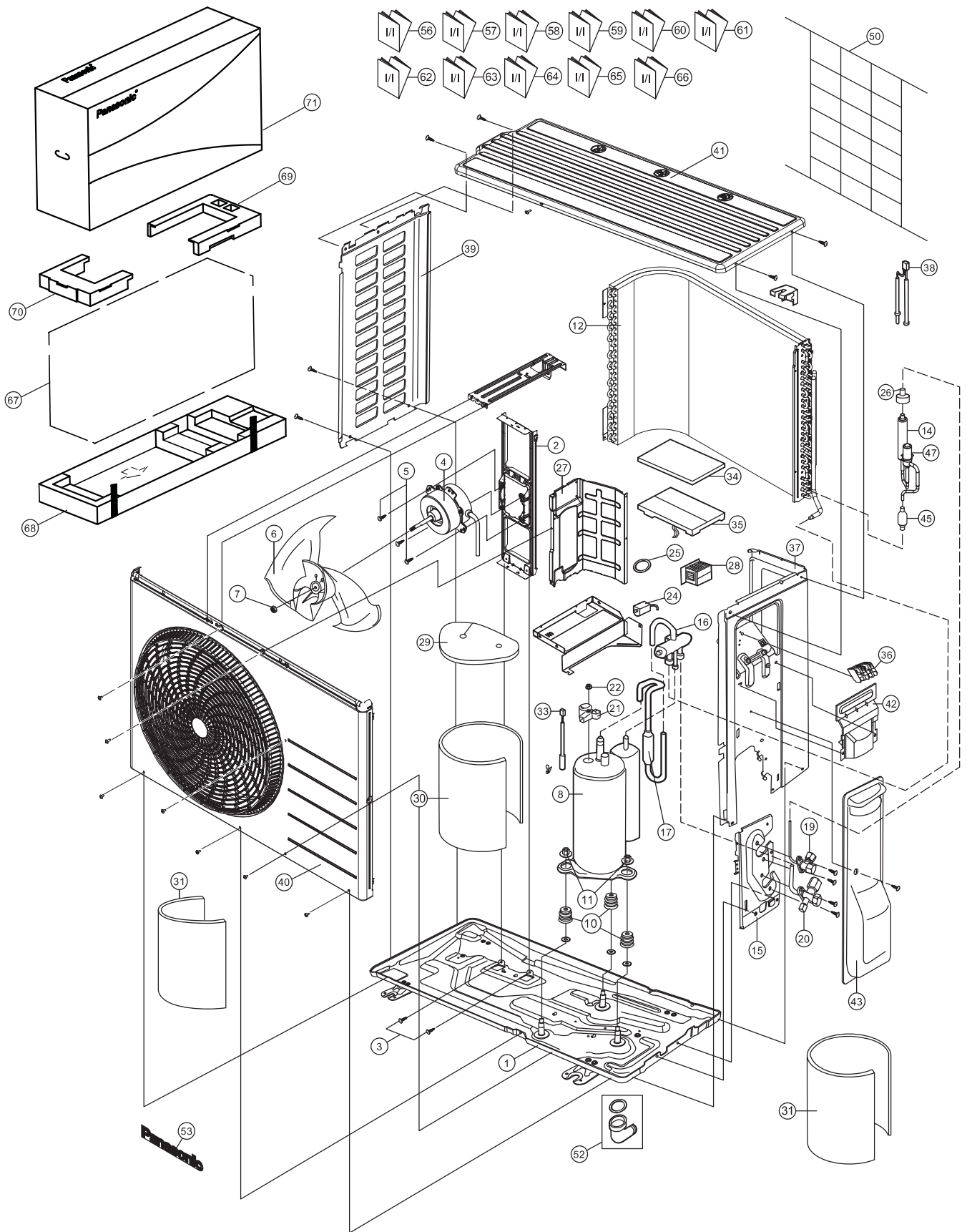

#### Note

The above exploded view is for the purpose of parts disassembly and replacement. The non-numbered parts are not kept as standard service parts.

SAFETY	REF. NO.	PART NAME & DESCRIPTION	QTY.	CU-Z20VKE	CU-Z25VKE	CU-Z35VKE	REMARK
	1	CHASSIS COMPLETE	1	CWD52K1399	←	←	
	2	FAN MOTOR BRACKET	1	CWD541157	←	←	
	3	SCREW - FAN MOTOR BRACKET	2	CWH551217	←	←	
⚠	4	FAN MOTOR	1	L6CAYYYL0064	←	←	O
	5	SCREW - FAN MOTOR MOUNT	4	CWH55252J	←	←	
	6	PROPELLER FAN ASSY	1	CWH03K1100	←	←	
	7	NUT - PROPELLER FAN	1	CWH56053J	←	←	
⚠	8	COMPRESSOR	1	KSK75D43UEE	9RS102XMA21	←	O
	10	ANTI - VIBRATION BUSHING	3	ACXH50-00970	CWH50077	←	
	11	NUT - COMPRESSOR MOUNT	3	CWH561096	←	←	
	12	CONDENSER	1	ACXB32C15080	ACXB32C00760	←	
	14	DISCHARGE MUFFLER	1	CWB121021	←	←	
	15	HOLDER COUPLING	1	CWH351233	←	←	
	16	4-WAYS VALVE	1	ACXB00-00130	←	←	O
	17	DISCHARGE MUFFLER (4 W. VALVE)	1	CWB121010	←	←	
	19	2-WAYS VALVE (LIQUID)	1	CWB021180J	CWB021654	←	O
	20	3-WAY VALVE (GAS)	1	CWB0111374	←	←	O
	21	TERMINAL COVER	1	ACXH17-01460	CWH171039A	←	
	22	NUT - TERMINAL COVER	1	ACXH56-00460	CWH7080300J	←	
⚠	24	V-COIL COMPLETE	1	ACXA43C00250	←	←	O
	25	O-RING	1	ACXB81-06510	←	←	
⚠	26	V-COIL COMPLETE	1	ACXA43C06110	←	←	O
	27	SOUND PROOF BOARD	1	CWH151427	CWH151428	←	
⚠	28	REACTOR	1	G0C752J00004	G0C392J00037	←	O
	29	SOUND PROOF MATERIAL - TOP	1	ACXG30-09030	CWG302314	←	
	30	SOUND PROOF MATERIAL - BODY	1	ACXG30-09020	CWG302948	←	
	31	SOUND PROOF MATERIAL	1	ACXG30-08500	CWG302316	←	
⚠	33	SENSOR CO - COMP TEMP	1	CWA50C2830	CWA50C2205	←	O
	34	CONTROL BOARD COVER - TOP	1	ACXH13-00450	←	←	
⚠	35	ELECTRONIC CONTROLLER - MAIN	1	ACXA73C52130R	ACXA73C50160R	ACXA73C50170R	O
⚠	36	TERMINAL BOARD ASSY	1	CWA28K1298	←	←	O
	37	CABINET SIDE PLATE CO.	1	ACXE04C00200	ACXE04C00460	←	
⚠	38	SENSOR CO - AIR TEMP AND PIPE TEMP	1	CWA50C3079	←	←	O
	39	CABINET SIDE PLATE	1	CWE041858A	←	←	
	40	CABINET FRONT PLATE CO.	1	CWE06C1566	←	←	
	41	CABINET TOP PLATE	1	CWE031230A	←	←	
	42	PLATE - C. B. COVER TERMINAL	1	CWH131301	←	←	
	43	CONTROL BOARD COVER CO.	1	CWH13C1359	←	←	
	45	STRAINER	1	CWB11094	←	←	
⚠	47	EXPANSION VALVE	1	CWB051078	←	←	
	50	WIRE NET	1	ACXD04-00040A	←	←	
	52	BAG - COMPLETE	1	CWG87C900	←	←	
	53	PANASONIC BADGE	1	CWE373439	←	←	
	56	INSTALLATION INSTRUCTION	1	ACXF60-33670	←	←	
	57	INSTALLATION INSTRUCTION	1	ACXF60-33680	←	←	
	58	INSTALLATION INSTRUCTION	1	ACXF60-33690	←	←	

SAFETY	REF. NO.	PART NAME & DESCRIPTION	QTY.	CU-Z20VKE	CU-Z25VKE	CU-Z35VKE	REMARK
	59	INSTALLATION INSTRUCTION	1	ACXF60-33700	←	←	
	60	INSTALLATION INSTRUCTION	1	ACXF60-33710	←	←	
	61	INSTALLATION INSTRUCTION	1	ACXF60-33720	←	←	
	62	INSTALLATION INSTRUCTION	1	ACXF60-33730	←	←	
	63	INSTALLATION INSTRUCTION	1	ACXF60-33740	←	←	
	64	INSTALLATION INSTRUCTION	1	ACXF60-33750	←	←	
	65	INSTALLATION INSTRUCTION	1	ACXF60-33760	←	←	
	66	INSTALLATION INSTRUCTION	1	ACXF60-33770	←	←	
	67	BAG	1	CWG861078	←	←	
	68	BASE BOARD - COMPLETE	1	CWG62C1223	←	←	
	69	SHOCK ABSORBER - RIGHT	1	CWG713778	←	←	
	70	SHOCK ABSORBER - LEFT	1	CWG713779	←	←	
	71	C. C. CASE	1	ACXG50-48860	←	←	

(NOTE)

- All parts are supplied from PAPAMY, Malaysia (Vendor Code: 00029488).
- "O" marked parts are recommended to be kept in stock.